

Sicherheits-Kupplungen Typ HSK
Safety Couplings Type HSK

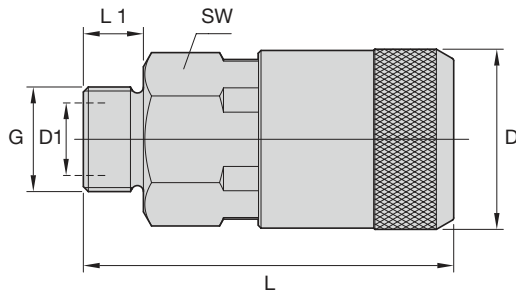

Bezeichnung Designation	Anschlussgewinde Thread G	Id. Nr. Id. No.	Durchgang Passage D1 Ø	D Ø	SW	L	L1
HSK0	G1/4"	6706634	4,0	28	24	61	8
	G3/8"	6706638				63	10
HSK1	G3/8"	6706647	7,5	36	30	72	10
	G1/2"	6706652				74	12
	G3/4"	6706661				77	15
HSK2	G1/2"	6706664	10,0	44	36	82	12
	G3/4"	6706669				85	15
HSK3	G3/4"	6706680	15,0	49	41	98	15
	G1"	6706686				102	20

Bestellbeispiel Example for ordering
 HSK1 / G 3/8"

Auch in Messing lieferbar
 Also available in brass

Schlauchtüllen Typ K-T, zum Befestigen des Schlauches
Hose Sockets Type K-T, to connect the hose

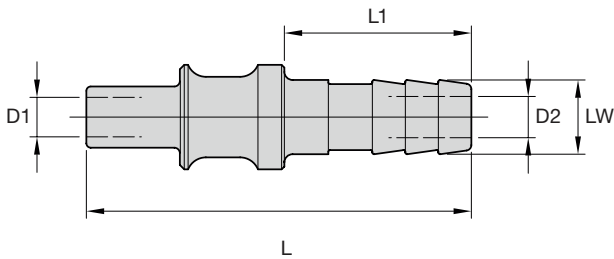

Bezeichnung Designation	LW	Id. Nr. Id. No.	passend in Kupplungen suitable for couplings HSK	Durchgang Passage D1 Ø	D2 Ø	L	L1
K-T0	6	6706774	0	4,0	4,0	60	28
	10	6706777					
K-T1	10	6706787	1	7,5	7,5	70	34
	13	6706788					
	10	6706802					2
13	6706803	10,0					
16	6706804						
K-T2	19	6706805	3	15,0	10,0	89	41
	13	6706823					
	16	6706824					
	19	6706825					
K-T3	25	6706827	3	15,0	15,0	89	41
	13	6706823					
	16	6706824					

Bestellbeispiel Example for ordering
 K-T1 LW 10

Auch in Messing lieferbar
 Also available in brass