

tappo maschio • male plug

OTPP

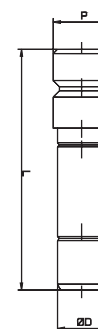

CODE	ØD	P	L	Peso Weight(g)	
OTPP 04	4	5	26,0	4,0	50
OTPP 06	6	7	29,0	5,0	50
OTPP 08	8	9	31,5	8,0	50
OTPP 10	10	11	35,0	11,0	50
OTPP 12	12	13	37,0	15,0	50



cartuccia in ottone • brass cartridge

OTCC



CODE	ØD	ØP	L	Peso Weight(g)	
OTCC 04	4	7,8	14,0	3,0	100
OTCC 06	6	10,0	16,0	7,0	100
OTCC 08	8	12,3	17,0	10,0	100

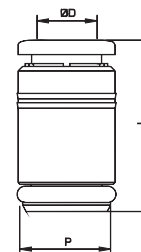

dettagli sede • details seat

CODE	ØD	L	S	Sm	ØF	ØG	ØP	L1	L2
OTCC 04	9,1	13,5	1X45°C	0,1X45°C	3,5	4	20	20,0	12,5
OTCC 06	11,1	15,5	1X45°C	0,1X45°C	5,1	6	20	20,0	12,5
OTCC 08	13,6	16,5	1X45°C	0,1X45°C	7,1	8	20	20,5	12,5

